

**REVISIONS**

DATE	NAME	NUMBER
12/9/88	DOUGLAS R. LONG	PE + LS 16341
12/12/90	IRA J. MILOVSKY	PE & LS 27053
9/23/93	JOHN R. WALKER	PE & LS 10294
1/14/94	JOHN R. WALKER	PE & LS 10294
4/13/95	JOHN R. WALKER	PE & LS 10294

**INDEX OF SHEETS**

SHEET NUMBER	BLOCK NUMBERS
8	42,43,51
9	51,52,53,54
10	54,55
11	56

KEY MAP 0.02

**NOTE:**

THE AREAS, BOUNDARIES AND DIMENSIONS, SHOWN ON THIS TAX MAP, ARE DERIVED FROM GROUND SURVEYS, AERIAL SURVEYS, AND RECORDED PLANS, MAPS, DEEDS, WILLS, AND ARE TO BE USED FOR ASSESSMENT PURPOSES ONLY.

**LEGEND**

- 2 DETAIL SHEET NUMBER
- 2 BLOCK NUMBER
- SHEET LIMIT
- \_\_\_\_\_ BLOCK LIMIT

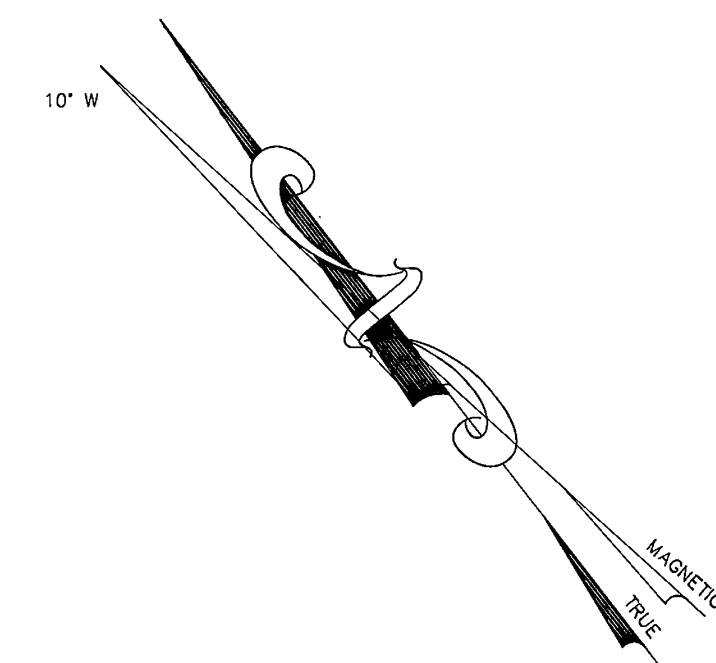
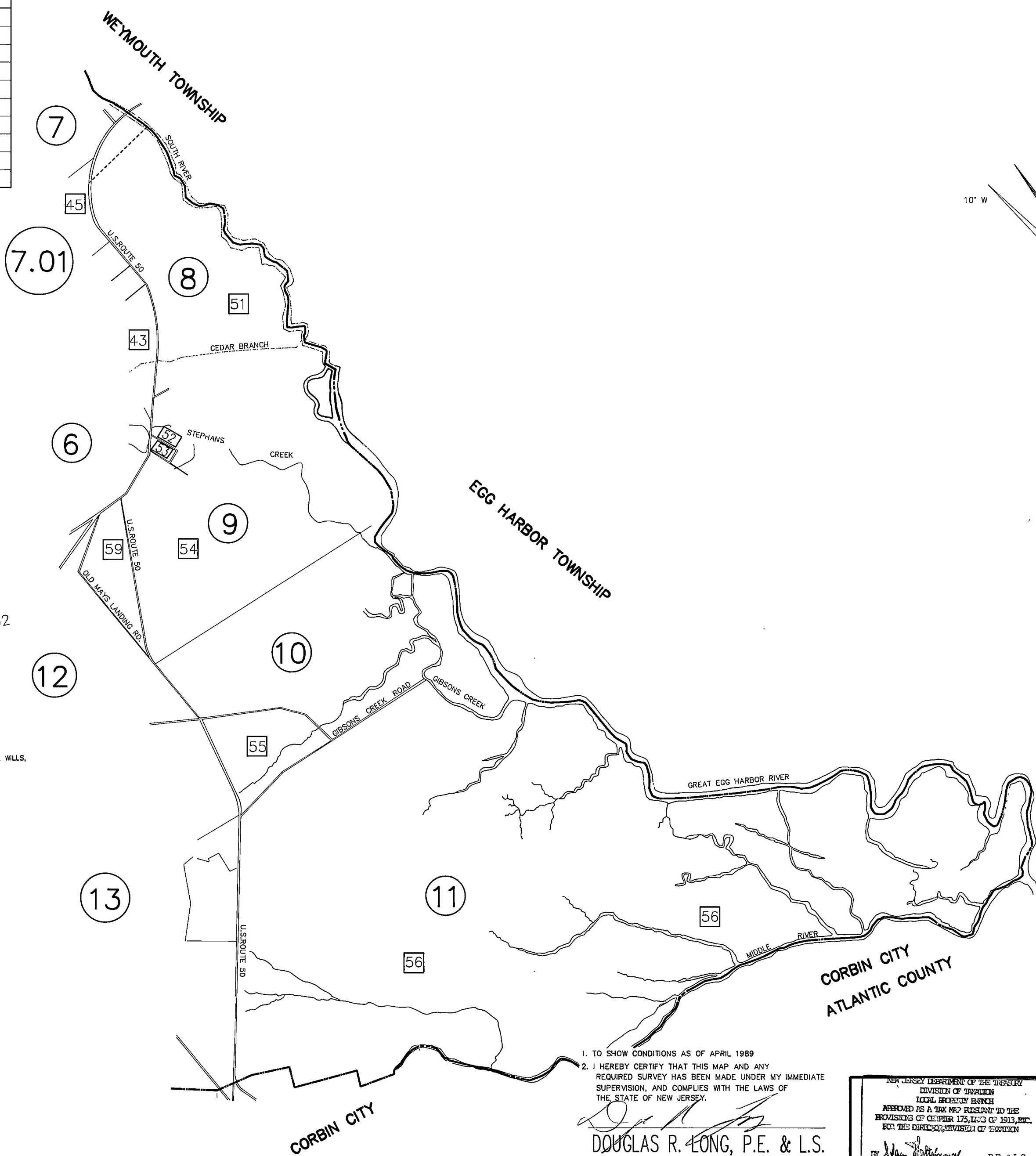

1. TO SHOW CONDITIONS AS OF APRIL 1989  
 2. I HEREBY CERTIFY THAT THIS MAP AND ANY REQUIRED SURVEY HAS BEEN MADE UNDER MY IMMEDIATE SUPERVISION, AND COMPLIES WITH THE LAWS OF THE STATE OF NEW JERSEY.

*Douglas R. Long*  
 DOUGLAS R. LONG, P.E. & L.S.  
 NEW JERSEY 16341

NEW JERSEY DEPARTMENT OF THE TREASURY  
 DIVISION OF TAXATION  
 LOCAL EXERCISES BRANCH  
 APPROVED AS A TAX MAP PURSUANT TO THE PROVISIONS OF CHAPTER 175, LEGIS. OF 1913, ETC.  
 BY THE DIRECTOR, DIVISION OF TAXATION

*Douglas R. Long* P.E. & L.S.  
 I.C.E. # 15430 CHIEF ENGINEERING SECTION  
 EXPIRES 14 1989 SERIAL NO. 700

**TAX MAP**  
 CITY OF ESTELL MANOR  
 ATLANTIC COUNTY, NEW JERSEY  
 SCALE: 1"=1000' APRIL 1989

**DOUGLAS R. LONG, P.E. & L.S.**  
 LONG ENGINEERING & SURVEYING CO.  
 591 N. Black Horse Pike Williamstown N.J. 08094